

# Cor-60 System with thermal break



# Cor-60 System with thermal break

## Transmittance

Uw from 1,0 (W/m<sup>2</sup>K)

Please consult typology, dimensions and glass

## Acoustic insulation

Maximum glazing: 46 mm.

Maximum acoustic insulation **Rw=48 dBA**

## Finishes

Possibility of dual colour

Colour powder coating (RAL, mottled and rough)

Wood effect powder coating

Anti-bacterial powder coating

Anodized

Air permeability

(EN 12207:2000): Class 4

Water tightness

(EN 12208:2000): Class E1200

Wind resistance

(EN 12210:2000): Class C5

Reference test 1,20 x 1,16 m. 2 sashes

Possibility of straight or curved sashes and beads

Possibility of incorporating hardware with concealed hinges.

Possibility of incorporating security hardware - Evo Security.



## Sections

Frame 60 mm.

Sash 68 mm.

## Profile thickness

Window 1,6 mm.

Door 1,6 mm.

Polyamide strip length 24 mm.

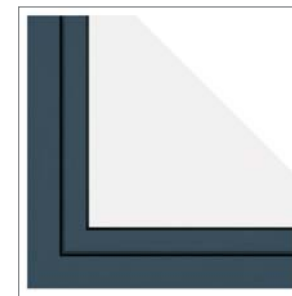
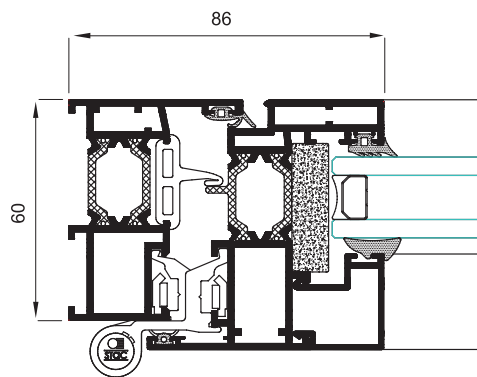

## Opening possibilities

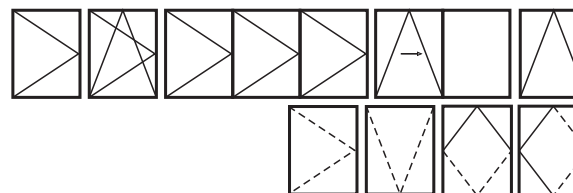

**Open in:** practicable, turn-tilt, folding, parallel tilt, hinged.

**Open out:** practicable, projecting-sliding, pivoting on horizontal or vertical axis

## Maximum dimensions/sash

Width (L) = 1.500 mm.

Height (H) = 2.600 mm.

Please consult regarding maximum weight and dimensions according to types

## Maximum weight/sash

120 Kg.