

**Cor-3500 System with thermal break**



# Cor-3500 System with thermal break

## Transmittance

Uw from 1,0 (W/m<sup>2</sup>K)

Please consult typology, dimensions and glass

## Acoustic insulation

Maximum glazing: 41 mm.

Maximum acoustic insulation **Rw=46 dBA**

## Finishes

Possibility of dual colour

Colour powder coating (RAL, mottled and rough)

Wood effect powder coating

Anti-bacterial powder coating

Anodized

## Categories achieved at test centre

Air permeability  
(EN 12207:2000): Class 4

Water tightness  
(EN 12208:2000): Class E1200

Wind resistance  
(EN 12210:2000): Class C5  
Reference test 1,20 x 1,20 m. 2 sashes

Possibility of straight or curved sashes and beads

Possibility of incorporating hardware with concealed hinges.

Possibility of incorporating security hardware - Evo Security.



## Sections

Frame 54 mm.  
Sash 63 mm.

## Profile thickness

Window 1,5 mm.  
Door 1,7 mm

Polyamide strip length 24 mm.

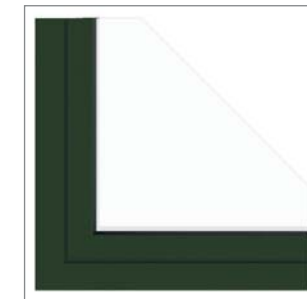
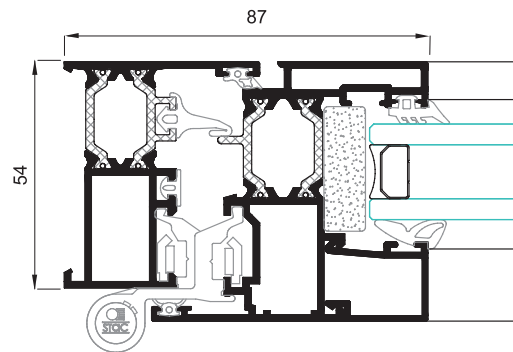

## Opening possibilities

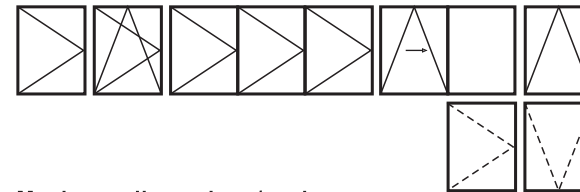

**Open in:** practicable, turn-tilt, folding, parallel tilt, hinged.

**Open out:** practicable, projecting-sliding.

## Maximum dimensions/sash

Width (L) = 1.500 mm.  
Height (H) = 2.400 mm.

Please consult regarding maximum weight and dimensions according to types

## Maximum weight/sash

120 Kg.