

ST 52 Façade

A new generation of façade consisting of a base system with an ample range of mullions and transoms that provides answers to the different style and construction needs for architectural projects.

Its base profile range of 16 mm to 250 mm in mullions and 22.5 mm to 255.5 mm in transoms, and equally with the complementary accessories, are common to the new CORTIZO façades. The extensive profile range and their mechanical unions allows for all types of façades to be built (vertically, inclining, 90° corners, corners and polygonals) as well as resolving large and heavy modulations.

With this **ST 52 façade** the glass is glued to an aluminium frame using structural silicone. The fixing of the glass-frame set to the supporting profiles is done by using the system's clips.

The style characteristic of this system is to offer the same aspect, whether with fixed glazing or with practicables, both in the exterior as in the interior.

Its glass only external style is with an open groove and the first weather barrier being an EPDM gasket which is installed around the perimeter of each module. An overlap closes the space between the gaskets.



ST52 Façade

Transmittance

Ucw from 0.7 (W/m²K)

Please consult dimensions and glass

Glazing

Maximum glazing: 38 mm.

Mínimum glazing: 6 mm.

Finishes

Colour powder coating (RAL, mottled and rough)

Wood effect powder coating

Anti-bacterial powder coating

Anodized

Categories achieved at test centre

Air permeability
(EN 12152:2000): Class AE

Water tightness
(EN 12154:2000): Class RE₇₅₀

Wind resistance
(EN 13116:2001): APT
(design loading 1200 Pa–security loading 1800 Pa)
Test reference 3,00 x 3,50 m.



Internal seen section

Mullion 52 mm.

Transom 52 mm.

Profile thickness

2,1 & 3,0 mm.

2,1 mm.

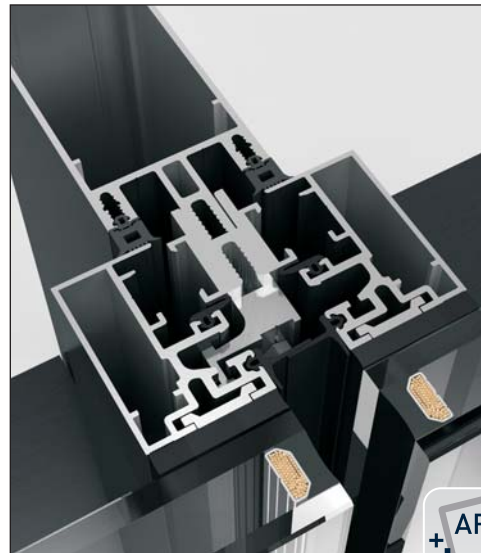
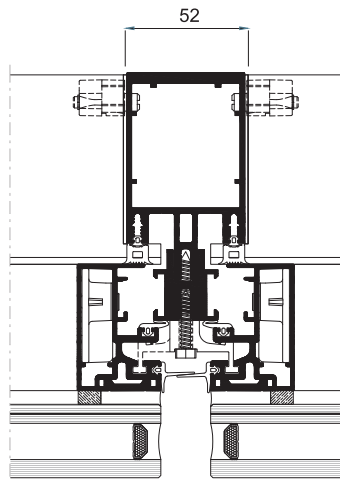

Opening possibilities

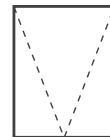

Hidden projecting

Maximum / Low dimensions

Projecting opening

Max. Width (L) = 2.500 mm. Min. Width (L) = 550 mm.
Max. Height(H) = 2.500 mm. Min. Height (H) = 650 mm.

Maximum weight

Projecting opening 180 Kg.